

INSTALLATION INSTRUCTIONS

① Package content

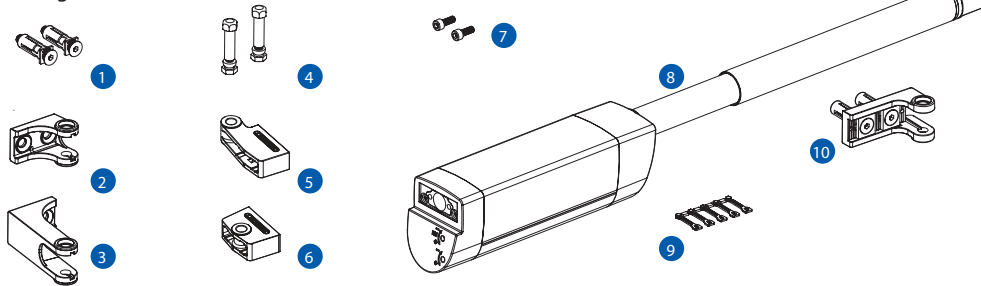

1. Quick-Fix
2. 90° and Moroccan hinge post bracket
3. 180° post bracket
4. Fixation bolts
5. 90° and Moroccan hinge tail bracket
6. 180° tail bracket
7. Tail bracket bolts
8. Samson gate closer
9. Plastic filler plugs
10. Gate bracket

② Mounting situations

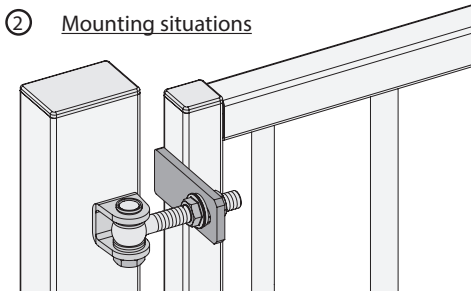

② Mounting situations

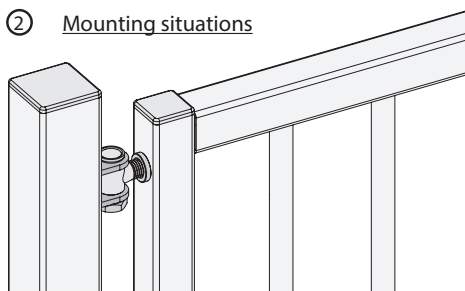

② Mounting situations



③ Accessories

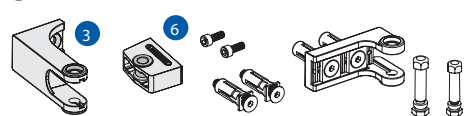

③ Accessories

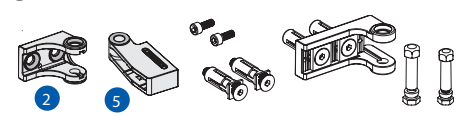

③ Accessories

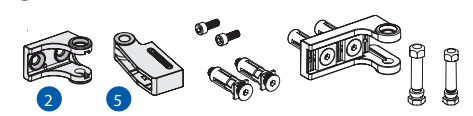

④ Profile and gate preparation

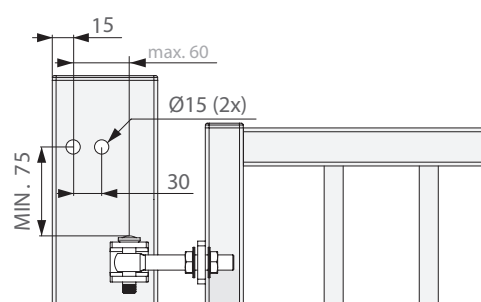

④ Profile and gate preparation

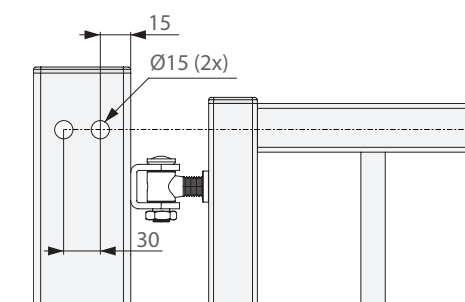

④ Profile and gate preparation

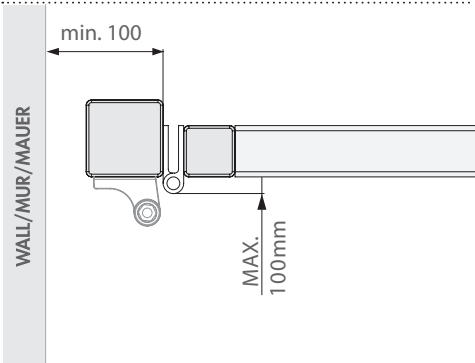
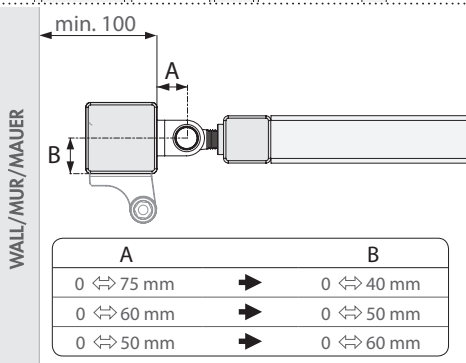
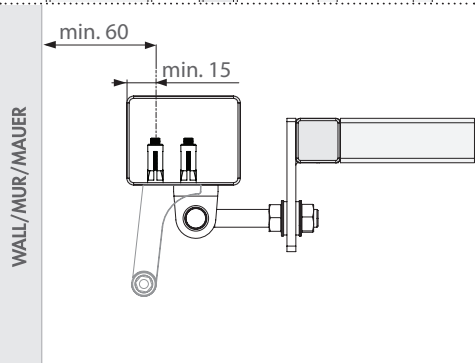
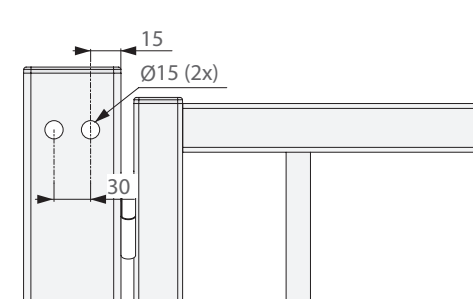

⑤ Mounting the brackets

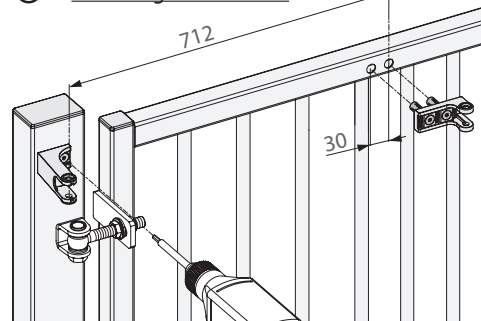

⑤ Mounting the brackets

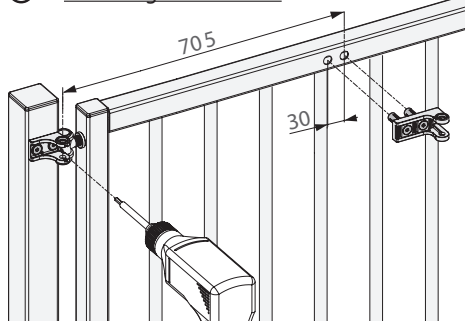

⑤ Mounting the brackets

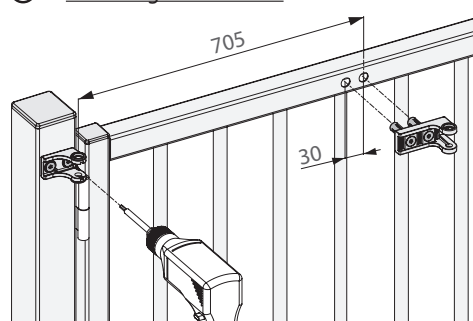

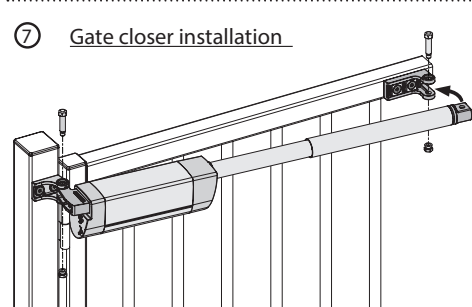
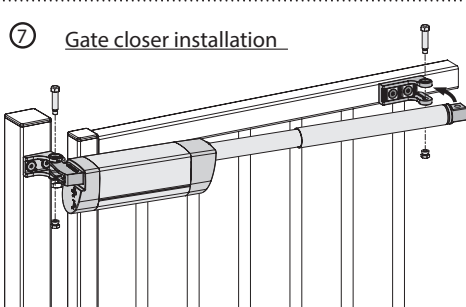
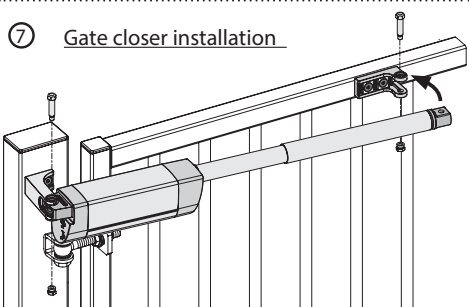
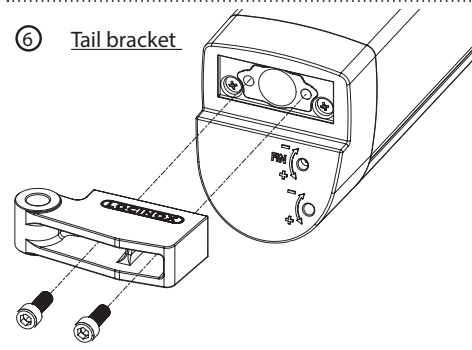
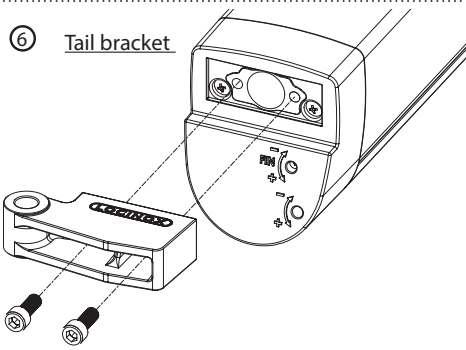
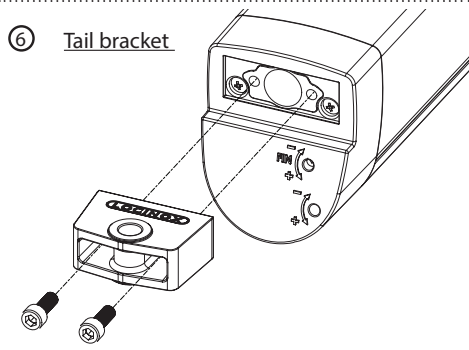
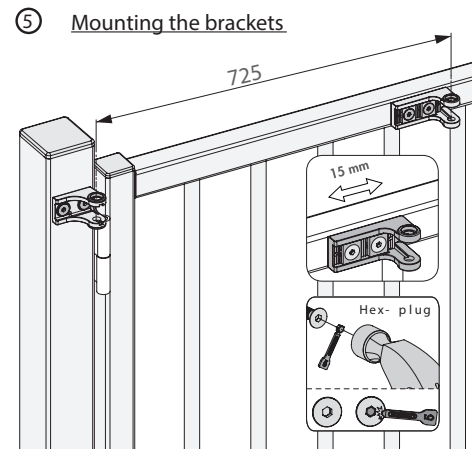
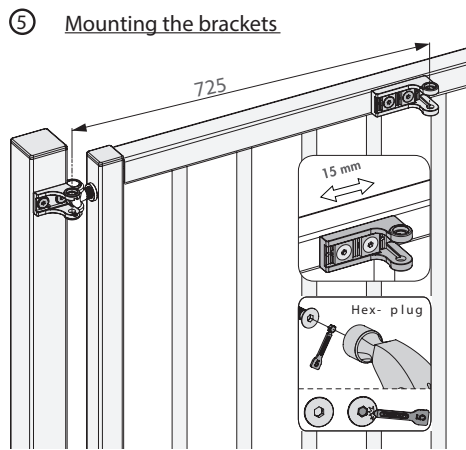
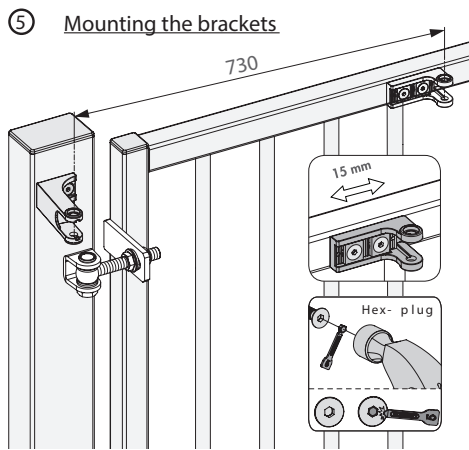

ADJUSTMENTS AND ANTI-THEFT PROTECTION

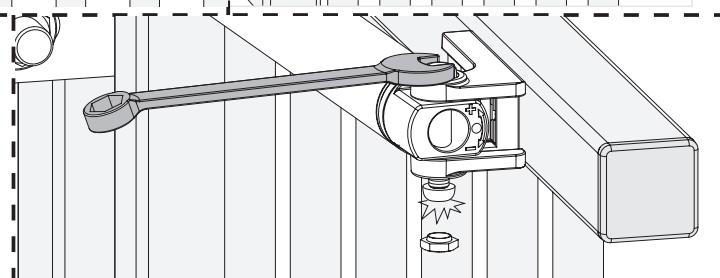
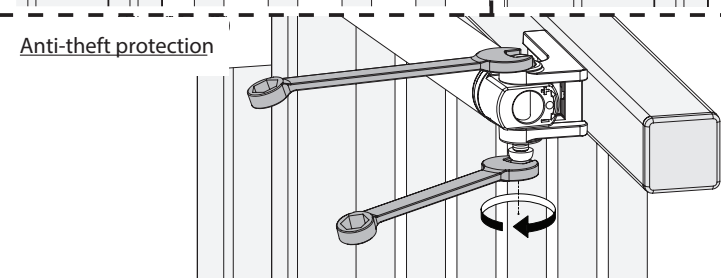
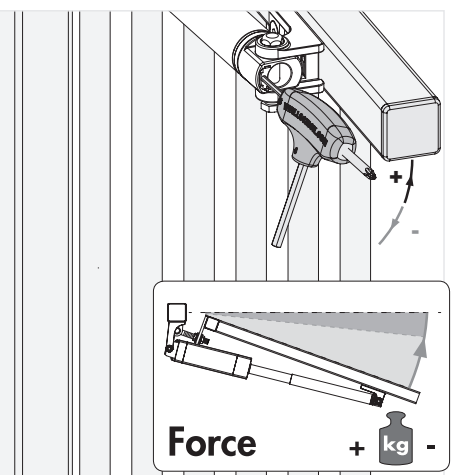
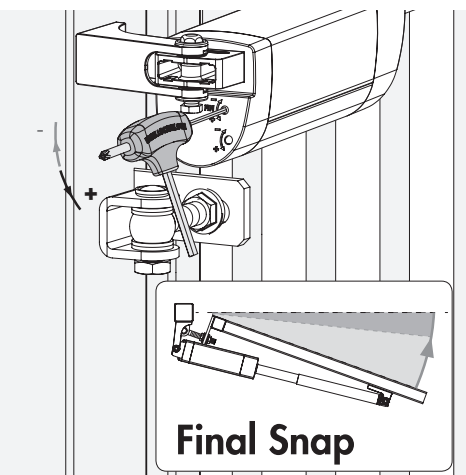
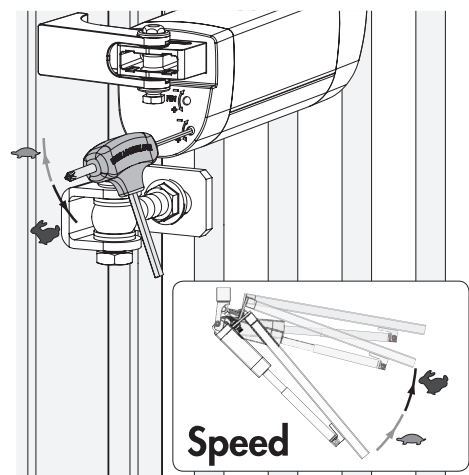

Whilst every effort has been made to ensure the accuracy of the information supplied, F.H.Brundle cannot be held responsible for any errors or omissions. This product must only be employed for its original intended use. Any other use is wrong and potentially dangerous. Installation must be carried out in full compliance with current regulations. F.H.Brundle cannot be held liable for any damages resulting from wrongful, erroneous or negligent use.