

ITEM NO.	PART NUMBER	DESCRIPTION	Material	Finish	QTY.
1	05SP02 Part1	Base of Security Post	Plain Carbon Steel	Yellow Zinc Plated	1
2	05SP02 Part2	80 x 80 x 3 SHS Post - 5mm Welded Cap With 20 x 5mm Folded Handle	Plain Carbon Steel	Yellow Zinc Plated	1
3	05SP02 Part3	Hinged Cover Cap	Plain Carbon Steel	Yellow Zinc Plated	1
4	05SP02 Part4	Folded Housing For 3G115 - 5 Lever Mortice Deadlock	Plain Carbon Steel	None	1
5	05SP02 Part5	Ø12 x 100mm Mild Steel Bar	Plain Carbon Steel	None	1
6	N/A	Mortice Deadlock	N/A	Polished Brass	1
7	N/A	M6 x 16mm Countersunk Head Hexagon Socket Drive Screw	Stainless Steel	N/A	1
8	N/A	M6 x 16 Prevailing torque type hexagon nuts (with non-metallic insert)	Stainless Steel	N/A	1
9	N/A	M5 x 16mm Countersunk Head Hexagon Socket Drive Screw	Stainless Steel	N/A	2
10	N/A	M5 x 15mm Prevailing torque type hexagon nuts (with non-metallic insert)	Stainless Steel	N/A	2

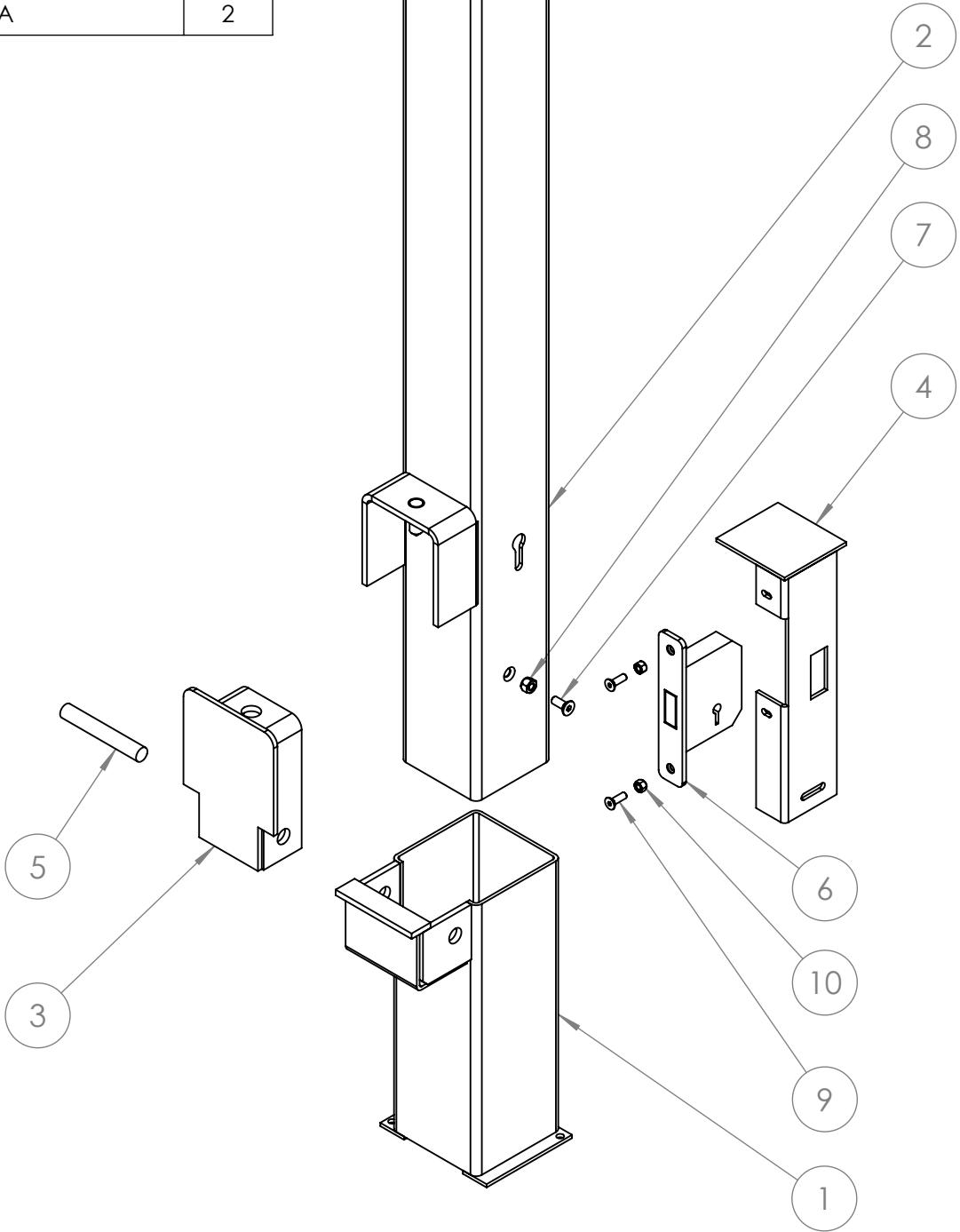
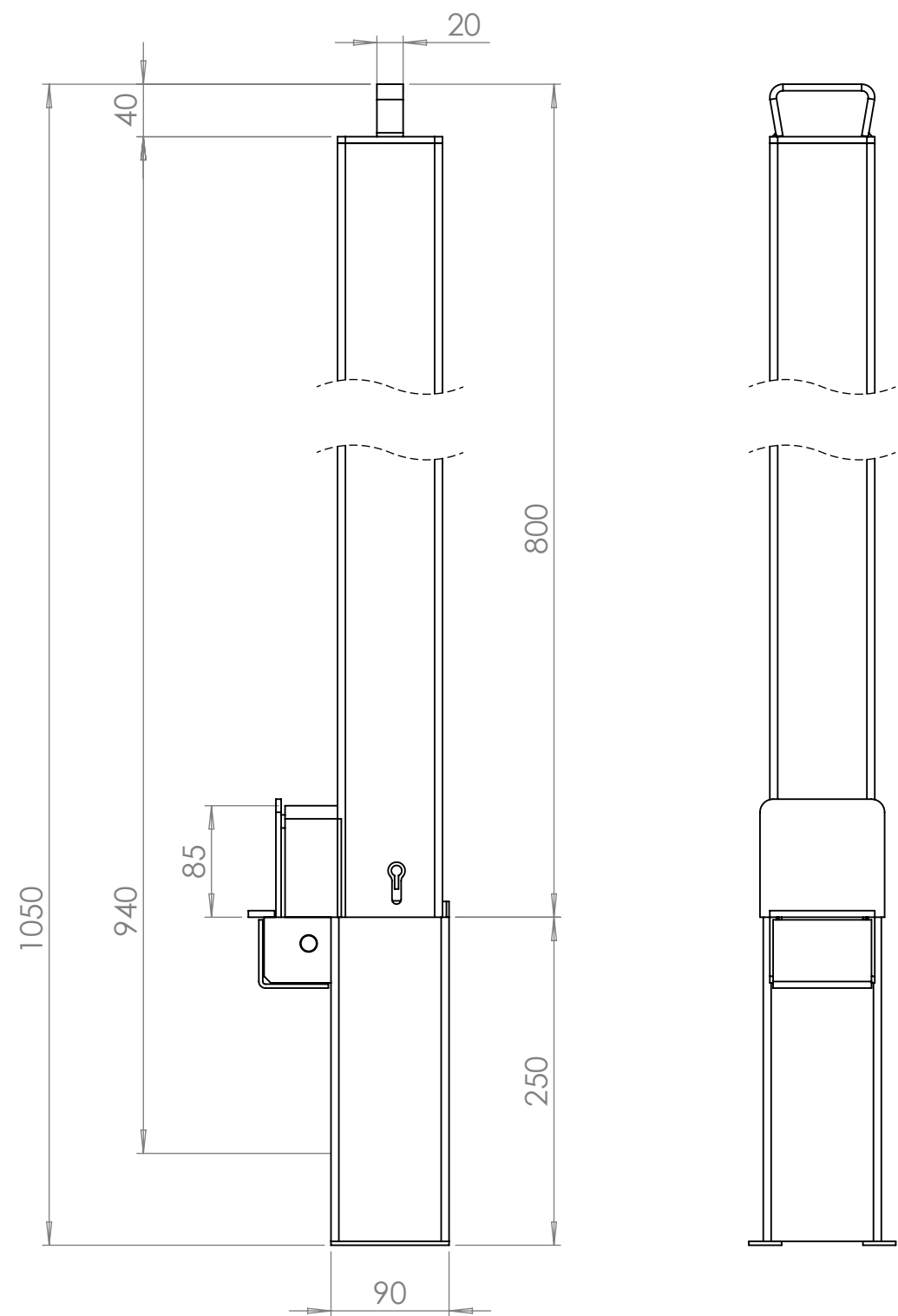

DESCRIPTION: Inpost Removable Security Post L800mm Built-in 5-lever Chubb Deadlock

	NAME	DATE	REVISION	UNLESS OTHERWISE SPECIFIED ALL DIMENSIONS ARE IN MILLIMETERS	
DRAWN	GC	19/141/2019	A		
CHECKED				DO NOT SCALE DRAWING	SCALE:1:5